

**KT34KIT:** max door weight: 60 lbs (27kg) = 2 hangers

### PARTS IN THE BOX



**KT34FLATH** Hanger (2 ea)  
**KT34OFFSETH** Hanger (offset) (2 ea)



**KT166** Flush pull, chrome, 3/4" (20mm) (2 ea)

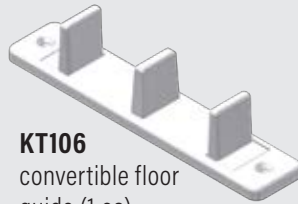

**KT106** convertible floor guide (1 ea)

Plus screws

### RECOMMENDED TOOLS

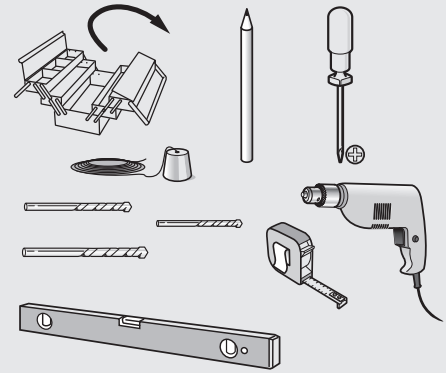

## 1 Size Doors

Trim doors 2-3/8" (60mm) less than opening height for 1/2" (13mm) floor clearance. Increase if more floor clearance is required.

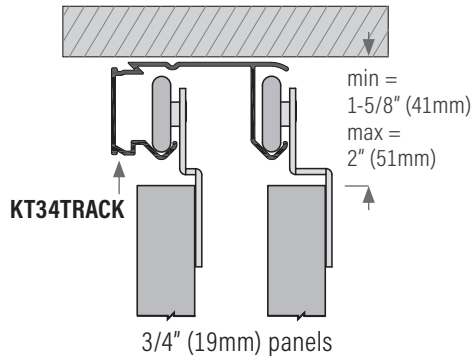

**KT102** Optional floor guides for 3/4" (19mm) panel thickness. Order separately.

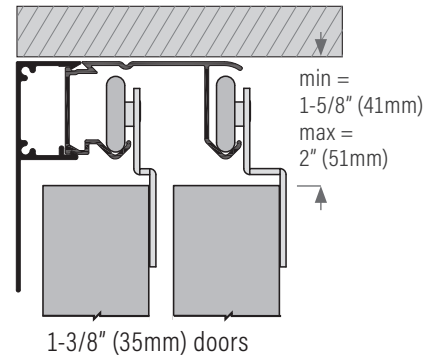

**NOTE:** KT106 guide will not work with 3/4" panels, use KT102 guide.

## 2 Install Track

Fasten track to header or ceiling backing with #8 screws.

## 3 Attach Hangers

Fasten to back of doors, 1-1/2" (38mm) in from edge as shown. Locate screws at top of slots for maximum adjustment.

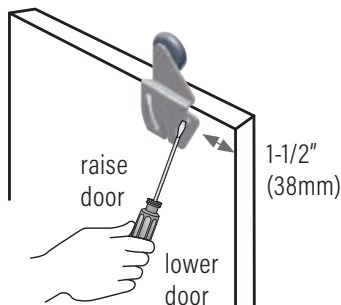

#### 4 Hang Doors & Adjust

Install rear door first. Tilt bottom of door out, lift and engage wheels in track. To adjust, loosen screws slightly and raise or lower by inserting screwdriver into adjusting slot.

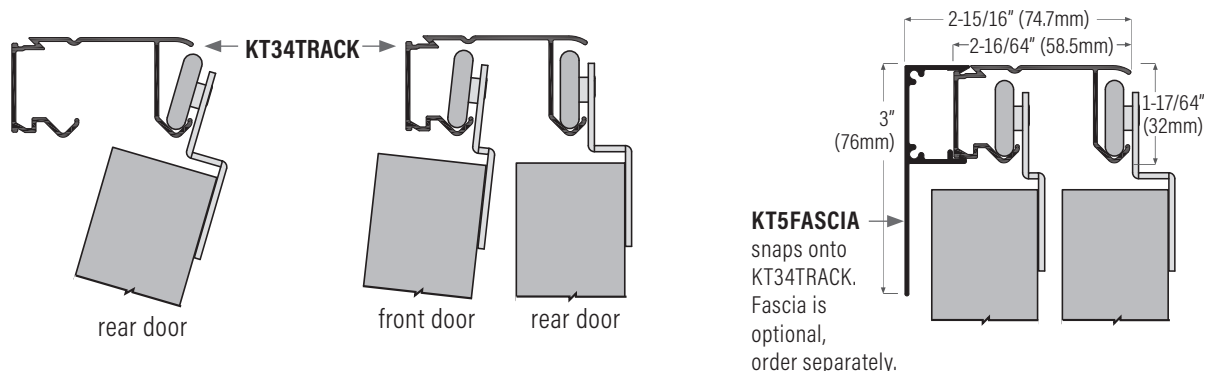

**KT5FASCIA**  
snaps onto  
KT34TRACK.  
Fascia is  
optional,  
order separately.

#### 5 Install Floor Guide

Slide both doors to the same side of opening. Assemble centre guide on base as shown and plumb face of front door in opening.

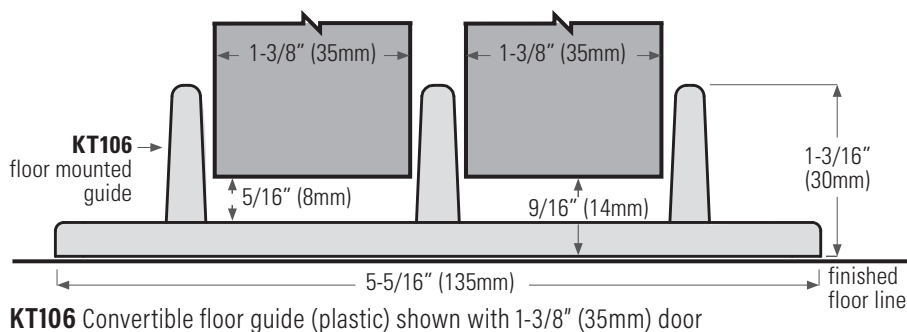

**KT106** Convertible floor guide (plastic) shown with 1-3/8" (35mm) door



#### Optional Floor Guide for 3/4" (19mm) Panels

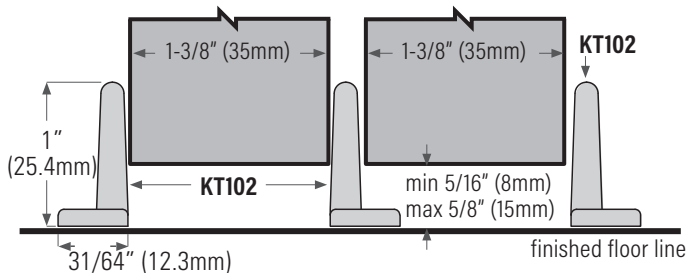

**KT102** Floor guide (plastic)

